

FES-WM1

取扱説明書
INSTRUCTION MANUAL

各部名称

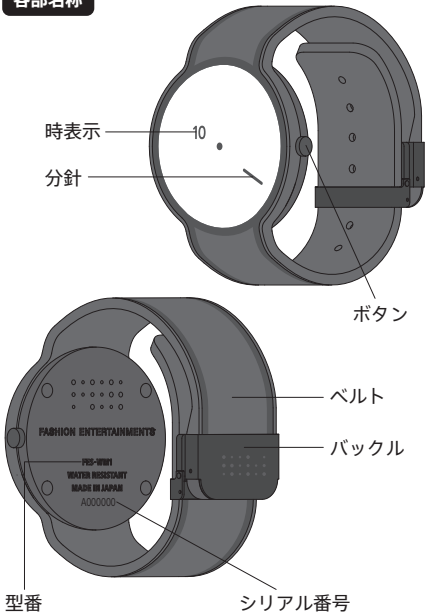

ベルトの長さを調節する

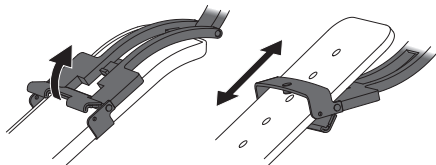

1. バックルにあるツメ部分を矢印方向にはずす。
2. バックルを移動し、ベルトの背面にある穴位置に合わせて固定する。

時刻を合わせる

1. ボタンを5秒以上押す。時表示が点滅します。
2. ボタンを繰り返し押して、時表示を合わせる。
3. ボタンを2秒以上押す。分針が点滅します。
4. ボタンを繰り返し押して、分針を合わせる。
5. ボタンを2秒以上押す。時刻設定が完了します。

時刻を表示する

- ボタンを押す



- ウォッチアクションをする

ウォッチアクション機能は工場出荷時オフです。ボタンを8秒以上押すとオン・オフが切り換わります。ウォッチアクション機能オンの場合、電池消費量が増します。

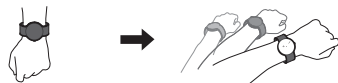

腕を下ろした状態から、時計を見る動作をする。



腕をひねる動作をする

柄を変える

時刻が表示されている状態の柄を変える：ボタンを押す。
時刻が表示されていない状態の柄を変える：ボタンを2秒以上押す。

詳しくは、下記をご覧ください。
Fashion Entertainments <http://fashion-entertainments.com>

取扱上のご注意

● **ベルトの取扱**：ベルト部を腕に装着する以上の角度で曲げること、ひねること、広げること、つぶすことはしないでください。
● **ショック**：落下や衝突など強いショックを与えないでください。本製品をかばんの中などに入れる場合は、ご購入時の箱に入れるなど保護をしてください。
● **静電気**：静電気を加えないでください。
● **磁気**：磁気(磁石など)に近づけると、時刻に進みや遅れが生じる場合があります。故障の原因ともなりますので、できるだけ磁気から遠ざけて保管し、ご使用ください。
● **温度**：時計が正常に動作する温度範囲は+5℃～+35℃です。
● **紫外線**：直射日光など紫外線が当たる場所に長時間放置しないでください。本製品が変色する可能性があります。
● **電池交換**：電池交換はお客様ご自身では行わず、お問い合わせ窓口にお申し付けください。
● **防水**：防水に配慮した設計をしておりますが、海水やお風呂などへの入水、直接水をかけるなどの行為はお控えください。
● **お手入れ**：本製品に汚れ、汗、水滴、油等が付着した場合は、吸湿性の良い柔らかな布ですみやかに拭き取ってください。



保証とアフターサービス

本製品は、保証書の内容に従って保証いたします。保証、修理、電池交換、その他不明な点がございましたら、お問い合わせ窓口へご相談ください。

● お問い合わせ窓口
Fashion Entertainments <http://fashion-entertainments.com>
・修理のご相談
フリーダイヤル：0120-222-330
携帯電話・PHS・一部のIP電話：050-3754-9599
FAX：0120-333-389

ソニー株式会社
〒108-0075 東京都港区港南1-7-1



4-573-955-12(1)

Parts Identification

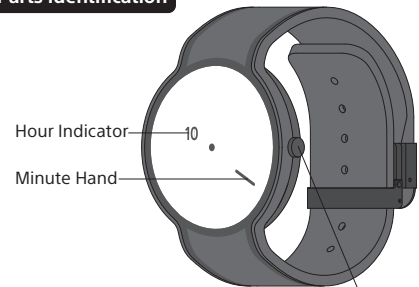

Button

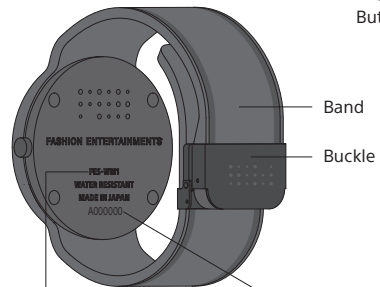

Model No.

Serial No.

Adjusting length of the band

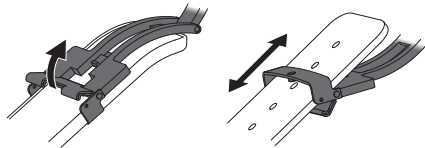

1. Unlock the latch of the buckle to the direction of the arrow to unlock.
2. Unlock the buckle and adjust to a hole on the back of the belt.

Adjusting the time

1. Press and hold the button for more than 5 seconds until the hour indicator flickers.
2. Press the button briefly and repeatedly to adjust the hour indicator.
3. Press and hold the button for more than 2 seconds until the minute hand flickers.
4. Press the button briefly and repeatedly to adjust the minute hand.
5. Press and hold the button for more than 2 seconds to finish the procedure.

Displaying the time

- Press the button



- Watch action

The factory default for Watch action is off. Press and hold the button for more than 8 seconds to toggle on and off. The battery consumption increases when Watch action is on.



Put your arm down with the watch placed around your wrist and bring the arm up to see the time.



Twist your wrist

Changing the pattern

To change the pattern while the time is displayed on the watch, push the button briefly. To change the pattern while the time is not displayed on the watch, push and hold the button for more than 2 seconds.

For more information, please go to URL below.
Fashion Entertainments <http://fashion-entertainments.com/en/>

CAUTION

- **Band** : Do not bend, twist, or spread, squash the band beyond the necessary minimum range required to wrap around your wrist.
- **Shock** : Avoid dropping the watch or subjecting it to other strong impact. When you carry the watch in your bag, please protect the watch, for example, by putting the watch into the original box you received upon purchase.
- **Static electricity** : Avoid exposing the watch to static electricity.
- **Magnetism** : Subjecting the watch to strong magnetism may prevent the watch from indicating the correct time. Keep away from all the magnetic devices to prevent the watch from malfunction.
- **Temperature** : This watch operates normally within +5°C to +35°C. Do not use or place the watch at a location where the temperature is beyond the limit of this range.
- **Ultra violet rays** : Do not expose the watch to direct sun light or ultra violet rays for many hours. It may cause discoloration of the product.
- **Battery exchange** : In case of exchanging the battery, please ask the below contact. Do not exchange battery by yourself.
- **Water resistant** : Water resistance for occasional splashing and rain. Do not operate the button while the watch is wet.
- **Caring for your watch** : When dirt, moisture, oil, or any other related materials adhered to the watch, promptly wipe off with soft and water-absorbing cloth.
- **Battery** : Do not recharge. Keep loose batteries away from children.
- **For Customers in the USA:** You are cautioned that any changes or modifications not expressly approved in this manual could void your authority to operate this equipment.

NOTE:

This equipment has been tested and found to comply with the limits for a Class B digital device, pursuant to Part 15 of the FCC Rules. These limits are designed to provide reasonable protection against harmful interference in a residential installation. This equipment generates, uses, and can radiate radio frequency energy and, if not installed and used in accordance with the instructions, may cause harmful interference to radio communications. However, there is no guarantee that interference will not occur in a particular installation. If this equipment does cause harmful interference to radio or television reception, which can be determined by turning the equipment off and on, the user is encouraged to try to correct the interference by one or more of the following measures:

- Reorient or relocate the receiving antenna.
- Increase the separation between the equipment and receiver.
- Connect the equipment into an outlet on a circuit different from that to which the receiver is connected.
- Consult the dealer or an experienced radio/TV technician for help.

This device complies with part 15 of the FCC Rules. Operation is subject to the following two conditions: (1) This device may not cause harmful interference, and (2) this device must accept any interference received, including interference that may cause undesired operation.

For the State of California, USA only
Perchlorate Material – special handling may apply, See www.dtsc.ca.gov/hazardouswaste/perchlorate

Do not bend



Do not twist



Do not spread



Do not squash



WARNING

Do not expose the battery to excessive heat such as direct sunlight, fire or the like.

Warranty & After sales service

Please refer to attached sheet for the terms of limited warranty. If you have any questions regarding limited warranty, repair, battery replacement, or other matters, please inquire at the below contact.

- Contact
Fashion Entertainments <http://fashion-entertainments.com/en/>
- Owner's Record : This model number and the serial number are located this product. Record these numbers in the space provided below. Refer to them whenever you contact our service site regarding this product.
Model No. [] Serial No. []